

Rhif y Cais: **33C304B/ECON** Application Number

Ymgeisydd Applicant

**Menai Science Park**

**Cais amlinellol gyda rhai materion wedi eu cadw yn ôl ar gyfer dymchwel fferm presennol, codi parc gwyddoniaeth, creu maes parcio ynghyd a chreu mynedfa newydd i gerbydau yn / Outline application with some matters reserved for the demolition of the existing farm, erection of a science park, creation of a car park together with the creation of a new vehicular access at**

**Junction 7 of the A55 (wrth ymyl / near Cefn Du), Gaerwen**

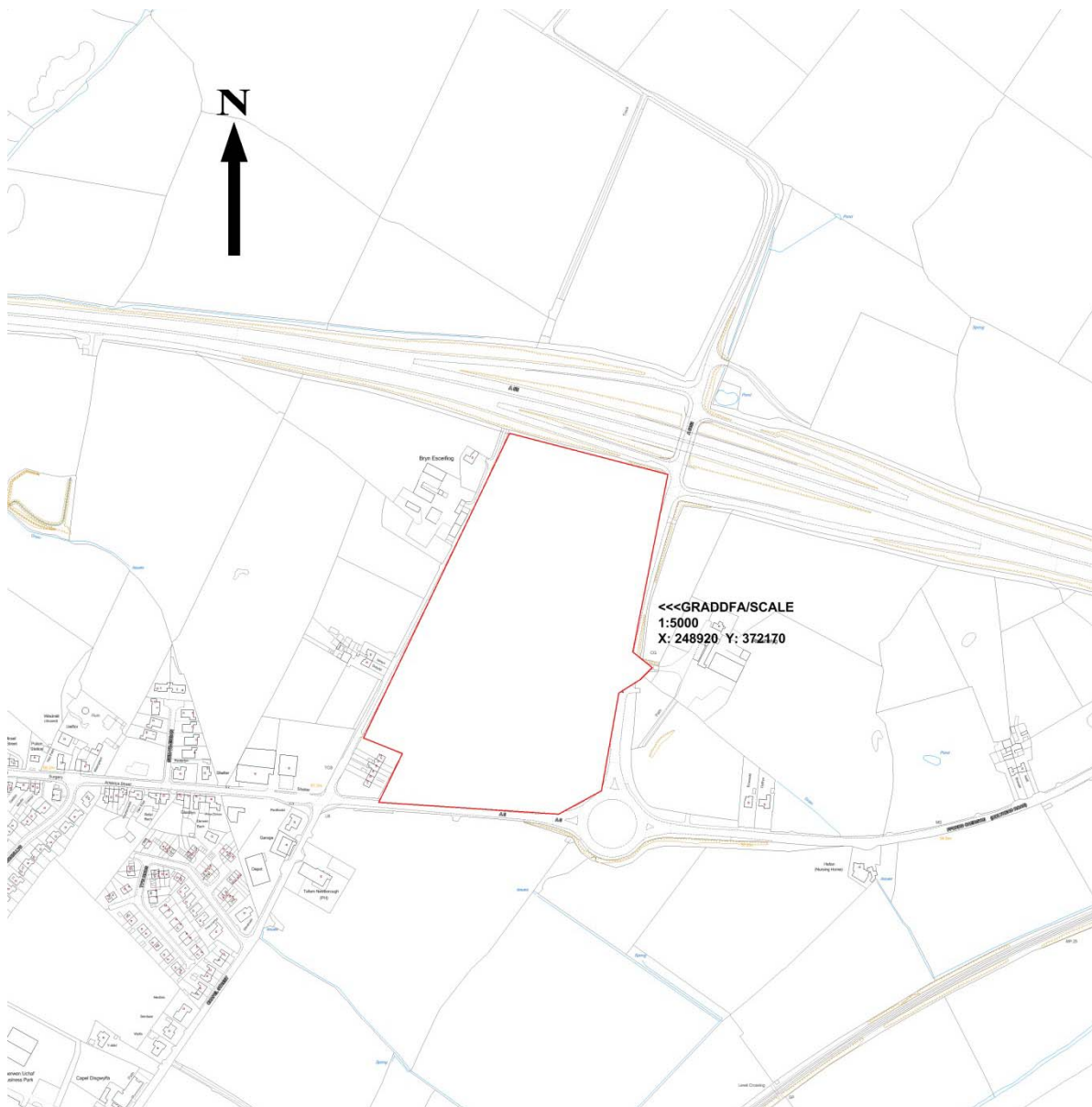

**Planning Committee: 01/04/2015**

**Report of Head of Planning Service (DFJ)**

**Recommendation:**

Defer

**Reason for Reporting to Committee:**

Members are informed that this application is being deferred as it is considered that there will be a conflict with the pre- election guidance given that each local authority is under a duty not to do or facilitate anything which could be used for political advantage during the election campaign.

Rhif y Cais: **34C553A** Application Number

Ymgeisydd Applicant

**St Malo (Llangefni) Ltd**

**Cais amlinellol ar gyfer datblygiad trigiannol yn cynnwys gwaith priffordd a rhydwaiith cysylltiol yn/Outline application for residential development, highway and associated infrastructure at**

**Ty'n Coed, Llangefni**

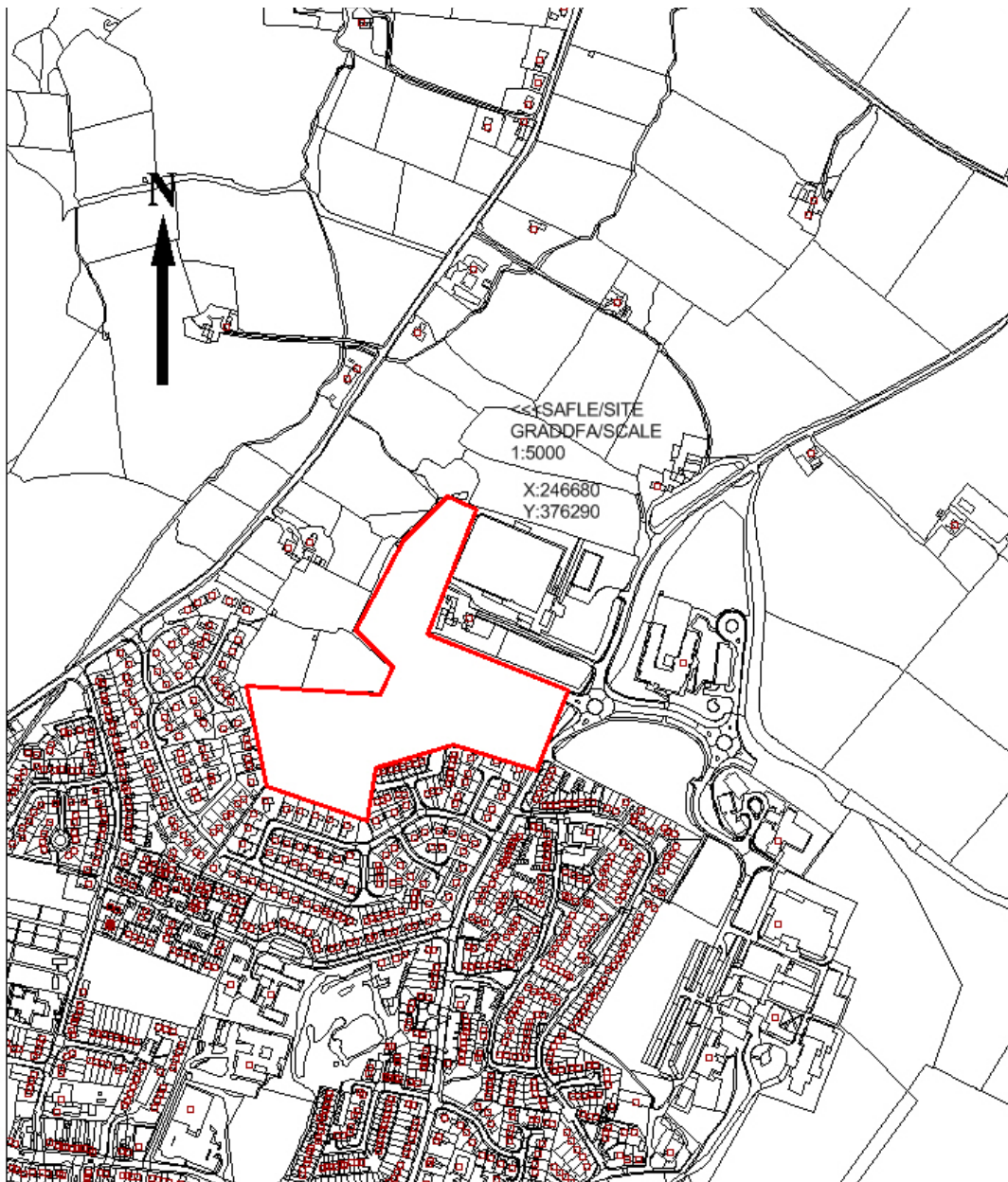

**Planning Committee: 01/04/2015**

**Report of Head of Planning Service (MTD)**

**Recommendation:**

Defer

**Reason for Reporting to Committee:**

Members are informed that this application is being deferred as it is considered that there will be a conflict with the pre- election guidance given that each local authority is under a duty not to do or facilitate anything which could be used for political advantage during the election campaign.